

PAM ANNUAL ARCHITECTURE STUDENT WORKS EXHIBITION 2022
5-9 OCTOBER 2022
GROUND FLOOR CENTRE COURT, 1 UTAMA SHOPPING CENTRE
BANDAR UTAMA, PETALING JAYA, SELANGOR

<p>A</p>	<p><u>INTRODUCTION</u></p> <p>Pertubuhan Akitek Malaysia (PAM) will organizing the 16th PAM Annual Architecture Student Works Exhibition 2022 from 5-9 October 2022 at Ground Floor Centre Court, 1Utama Shopping Centre, Bandar Utama, Petaling Jaya, Selangor.</p> <p>The objectives of this exhibition are as follows:</p> <ol style="list-style-type: none"> Public awareness on the process of educating an Architect, Public information of Architecture as a respectable career, Exposure of the Architecture schools in Malaysia and their products, and Exposure of architecture students to the public
<p>B</p>	<p><u>THEME</u></p> <p>This year's exhibition theme is "Unveiling the Imagination".</p> <p>The Covid-19 pandemic has limited architecture students' competitions and exhibitions within the virtual platform for over two years. This year, the 16th PAASWE is returning to One Utama Shopping Mall in October, which gives a platform and an opportunity to 20 architecture universities/institutions to display their selected students' works physically and in public after many years of virtual isolation. The word <i>Unveiling</i> in the theme is the method of revealing the architecture students' works through window louvres and other opening mediums. The word <i>Imagination</i> represents the students' imaginations, which were depicted in every project they have completed and shall be exhibited in the exhibition booths.</p> <div data-bbox="938 1043 1329 1541" data-label="Image"> </div> <p>Ref: Linvisible Box by Superstudio Più, curated by Giulio Cappellini.</p>
<p>C</p>	<p><u>SPONSOR</u></p> <div data-bbox="268 1659 703 1899" data-label="Image"> </div> <div data-bbox="735 1671 927 1888" data-label="Image"> </div> <div data-bbox="959 1659 1417 1899" data-label="Image"> </div> <p>There will be a monetary contribution from a window louvres design company called Breezway. In response to the PAASWE2022 theme, the exhibition booth should also include window louvres into their exhibition booth design. However, it should not limit the students from exploring various opening methods too.</p>

D

METHODOLOGY, SPACE AREA, BOOTH & DISPLAY ITEMS

- a) Each university/institution is required to design and build an exhibition booth according to the theme “Unveiling the Imagination”, within the build-up area, **2000mm(W) x 2000mm(L)**. The **height** of the exhibition booth should be within **2000mm to 2500mm**. The structure should be sound to stand and hold students’ works. The whole structure (including footing or protruding elements) should be within the given build-up area for safety purposes. Any booth that exceeds the size limit will be penalized in the markings.
- b) The exhibition booth should include a window louvre design inspired by Breezway products **and** any method of opening e.g., bi-fold door with louvres, fixed lite windows with louvres.
- c) The content and arrangement of the items that shall be displayed play important roles in this competition. The students’ works should be displayed skillfully onto their exhibition booth structure. It should be informative, comprehensive with an interesting narrative, and aesthetically pleasing. 70% of the exhibition booth design must be related to the exhibition theme.
- d) The installation must be original and **not** being recycled from other events such as Architectural Workshop and etc.
- e) The assembling and disassembling of booth clearly begin from 11.00 pm only and must be loaded or unloaded via the designated Loading Bay at LG Floor. Any breach of rules will be penalized (loss of remuneration allowance and etc).
- f) Students who are involved in assembling/disassembling are required to apply for Security Pass in the Loading Bay area at LG Floor. PAM will not be responsible for any damages and penalties caused.
- g) The booth materials should be sturdy and properly constructed to maintain the safety of visitors/installation during the exhibition. The use of sharp edges or fire-hazardous materials is strictly prohibited. All structures must be at least 80% completed before being brought in for installation. The installation and exhibits must be easily assembled and disassembled within 3 hours. Strictly no heavy-duty tools are allowed during installation.
- h) No reservation room/space for the booth material. Each institution must have two (2) people standby at the booth every day.
- i) Each university/institution will be rated by the marks received during the judging session. Gold (86-90%), Silver (71-85%), Bronze (56-70%) and Participation (55% and below). 1 Winner will be decided and entitled to receive PAASWE2022 Best Booth Display Award 2022.
- j) Each booth will be judged based on the Theme Concept (10%), Presentation by students (10%), Functionality of Ventilation Concept (30%), Creativity (30%), and Endurance (20%).
- k) A student representative of each booth will present to the Panel of Jury on Saturday, 8 October 2022, at 2.00 pm on Ground Floor, Centre Court. The award will be announced and presented to the winners on Sunday, 9 October 2022, at 4.00 pm in the same area of the exhibition.

E	<p><u>ELIGIBILITY</u></p> <p>a) The space is limited to 20 booths only. Each university/institution will be allocated 1 booth space with 10 student members (attached is the registration form). Allocation of booth will be given based on first come first serve basis. The exhibition layout is given in page one. Any late registration will not be entertained.</p> <p>b) Participants must be registered in recognized Architecture School from university or institution in Malaysia.</p> <p>c) Participants must have a PAM student membership.</p>
F	<p><u>TIMELINE OF EXHIBITION</u></p> <p>29 August 2022 (Monday)</p> <ul style="list-style-type: none"> • Registration open <p>12 September 2022 (Monday)</p> <ul style="list-style-type: none"> • Submission of initial 3D sketch of proposed installation (plan, elevations, sections, perspective – A3 size, digital format, 300 dpi jpeg). • Submission must be in softcopy format (JPEG/PDF) via email at paaswe@gmail.com. No hardcopy submission required. <p>4 October 2022 (Tuesday)</p> <ul style="list-style-type: none"> • Installation of booth by university/institution from midnight (11.00 pm) until morning (9.00 am). <p>5 October 2022 (Wednesday)</p> <ul style="list-style-type: none"> • Exhibition starts (10.00 am) • Opening ceremony (2.00 pm) <p>8 October 2022 (Saturday)</p> <ul style="list-style-type: none"> • Exhibition starts (10.00 am) • Presentation of Booth and Judging Session to the Panel of Judges by university/institution (2.00 pm). <p>9 October 2022 (Sunday)</p> <ul style="list-style-type: none"> • Exhibition starts (10.00 am) • Closing Ceremony of PAASWE 2022 at Ground Floor Centre Court, 1Utama Shopping Centre (4.00 pm)

EXHIBITION LAYOUT PLAN 2

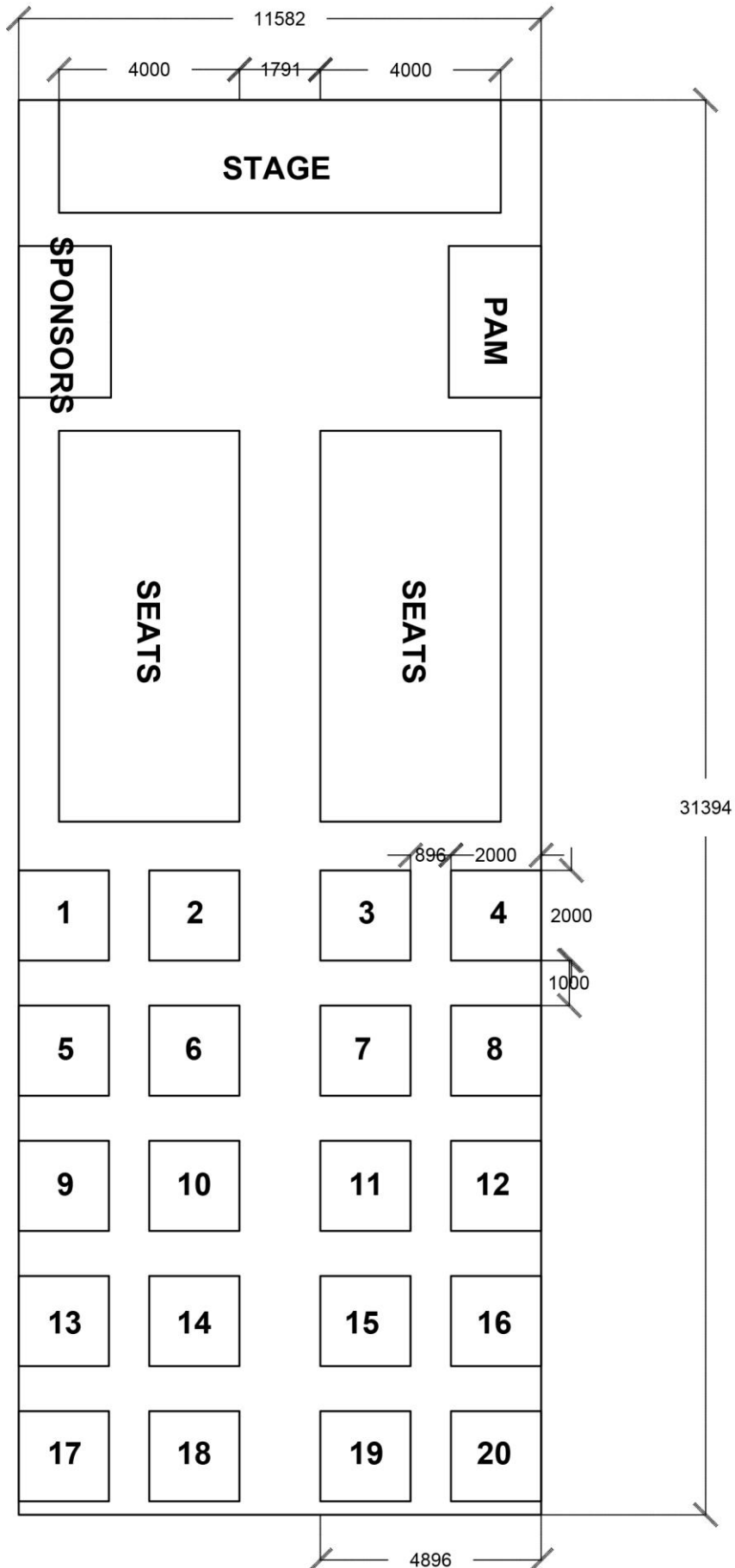

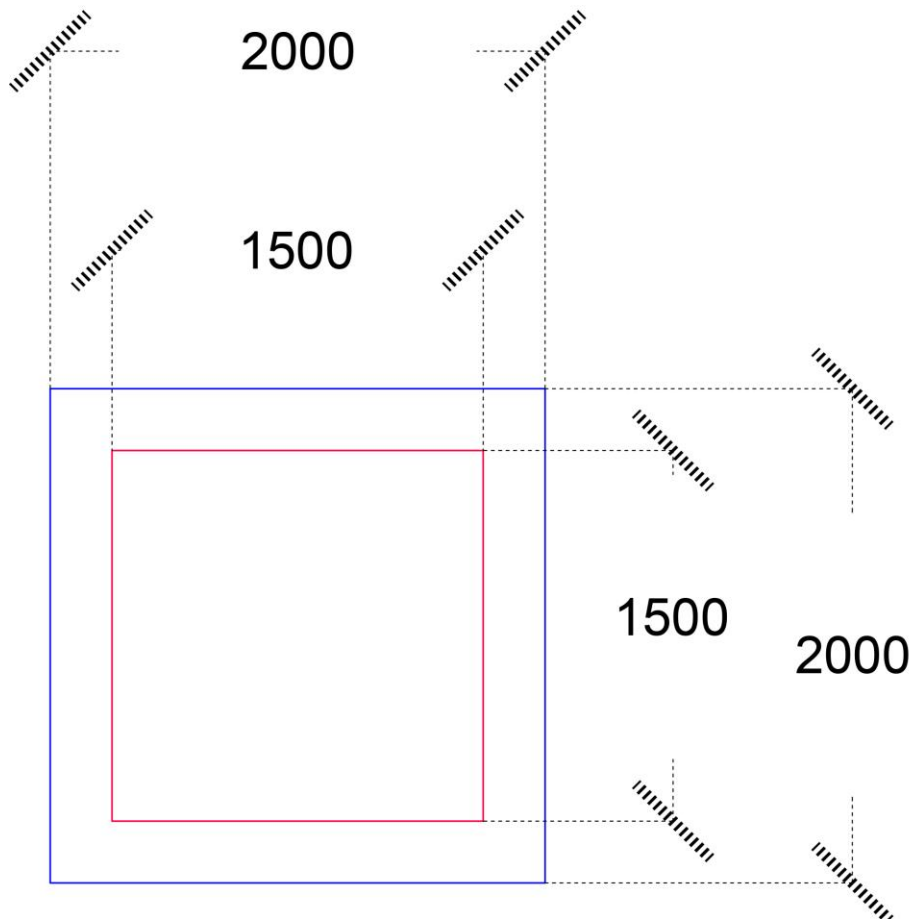

- Boundary for main structure
- Boundary for Build-up Area includes footings and other protruding elements

EXAMPLE FOR THE EXHIBITION BOOTH STRUCTURE

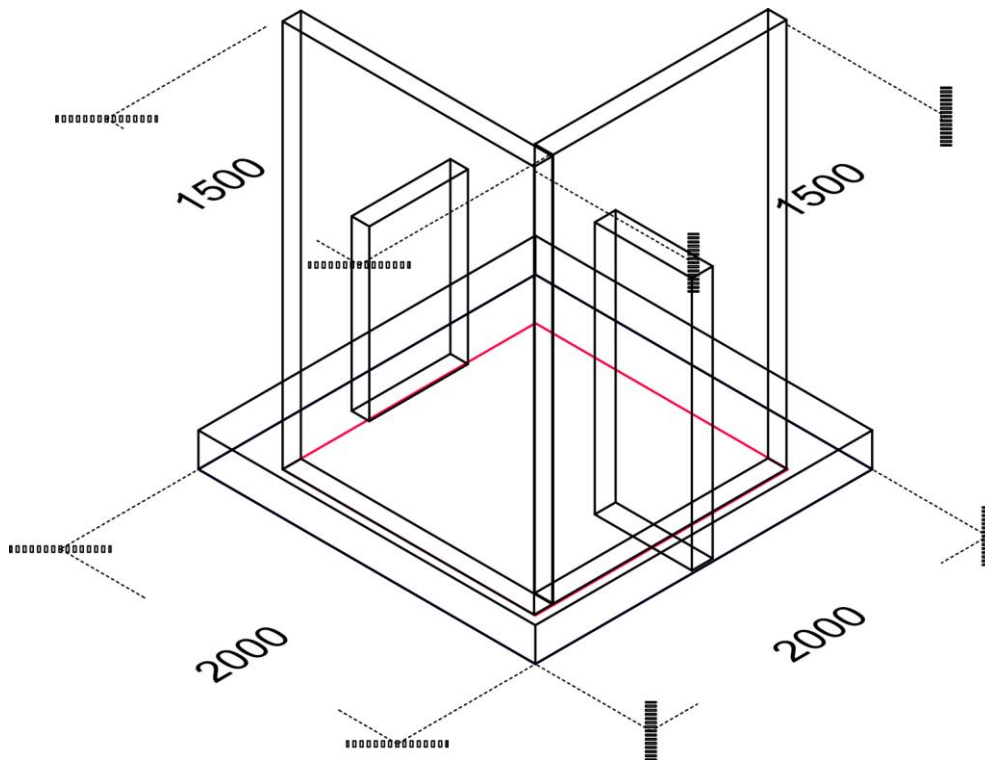

LOCATION AREA

